

DAYTON

SPECIFICATIONS

Dayton® Single Bowl Bar Sink
Model DP211515C

GENERAL

Sink bowl seamlessly drawn of heavy gauge, nickel bearing stainless steel.

DESIGN FEATURES

Bowl Depth: 5-1/8".

Coved Corners: Interior vertical and horizontal corners are rounded to a minimum of 2-3/4" radii.

Finish: Exposed surfaces are polished to a satin finish with a highshine bowl radius.

Underside: Fully undercoated to deaden sound.

Self-Rimming: Sink is furnished with appropriate number of clamps to provide a secure, watertight installation.

SINK PACKAGE

Model **DP211515C** bar sink is furnished with:

(1) **D11515** bar sink.

(1) **LKB24798**. Gooseneck bar faucet. Overall height, 8".

(1) **D5018A**. Drain fitting with basket strainer.

OTHER

Drain Opening: 2".

Faucet Holes: 2 faucet holes, 4" center to center.

This sink complies with ANSI Standard A112.19.3M.



This sink is listed by the International Association of Plumbing and Mechanical Officials as meeting the requirements of the Uniform Plumbing Code.



This Faucet is classified by Underwriters Laboratories Inc. to **ANSI/NSF61** for residential use.



This sink is listed with the Canadian Standards Association.

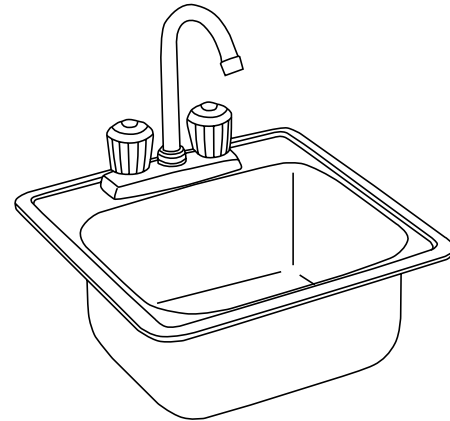

Model DP211515C

SINK DIMENSIONS (INCHES)*

Model Number	Overall		Inside Bowl			Cutout in Countertop (1 1/2" Radius Corners)		Ship. Wt. Lbs.
	L	W	L	W	D	L	W	
DP211515C	15	15	12	10	5 1/8	14 3/8	14 3/8	6 3/4

* Length is left to right. Width is front to back.

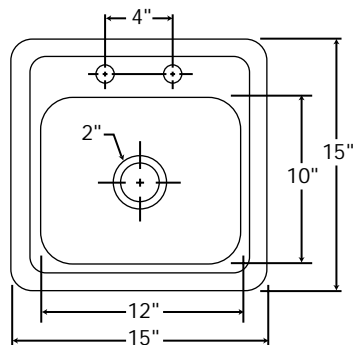

Bowl Depth is 5-1/8"

Model DP211515C Illustrated

ALL DIMENSIONS IN INCHES. TO CONVERT TO MILLIMETERS MULTIPLY BY 25.4.

In keeping with our policy of continuing product improvement, Elkay reserves the right to change product specifications without notice.

This specification describes an Elkay product with design, quality and functional benefits to the user. When making a comparison of other producers' offerings, be certain these features are not overlooked.

Elkay

www.elkayusa.com

2222 Camden Court
Oak Brook, IL 60523

Printed in U.S.A.
©2003 Elkay

(Rev. 10/03) 2-4D