

**Lustertone® Contemporary Gourmet
Single Bowl Sink
18 Gauge, Type 304, Self Rim
Models LCGR2522 and DLCGR252210**



SPECIFICATIONS

GENERAL

Highest quality. Sink bowls are seamlessly drawn of #18 gauge, type 304 (18-8) nickel bearing stainless steel. Self-rimming.

DESIGN FEATURES

Bowl Depth: 8" (LCGR); 10-1/2" (DLCGR).

Finish: Exposed surfaces are hand blended to a lustrous high-lighted Lasting Beauty satin finish.

Underside: Fully protected by heavy duty Sound Guard™ undercoating to prevent condensation and deaden sound.

Bowl is recessed 1/2" below outside edge of sink.

Minimum Recommended Sink Base: 30".

OTHER

Drain Opening: 3-1/2".

Faucet Holes: Available with 0, 1 or 2, 1-1/2" diameter faucet holes.

OPTIONAL ACCESSORIES

Rinsing Basket: LKRB1614 or DB1420.

Bottom Grid: LKOBG1821.

This sinks complies with ANSI Standard A112.19.3M.

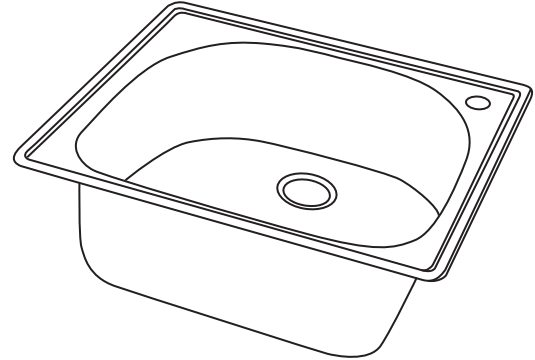

Model LCGR25221

SINK DIMENSIONS (INCHES)*

Model Number	Overall		Inside Bowl			Cutout in Countertop (1 1/2" Radius Corners)		Ship. Wt. Lbs.
	L	W	L	W	D	L	W	
LCGR25221	25	22	21	18 ⁵ / ₈	8	24 ³ / ₈	21 ³ / ₈	14 ¹ / ₂
LCGR2522S2	25	22	21	18 ⁵ / ₈	8	24 ³ / ₈	21 ³ / ₈	14 ¹ / ₂
DLCGR2522101	25	22	21	18 ⁵ / ₈	10 ¹ / ₂	24 ³ / ₈	21 ³ / ₈	15
DLCGR252210S2	25	22	21	18 ⁵ / ₈	10 ¹ / ₂	24 ³ / ₈	21 ³ / ₈	15

*Length is left to right. Width is front to back.

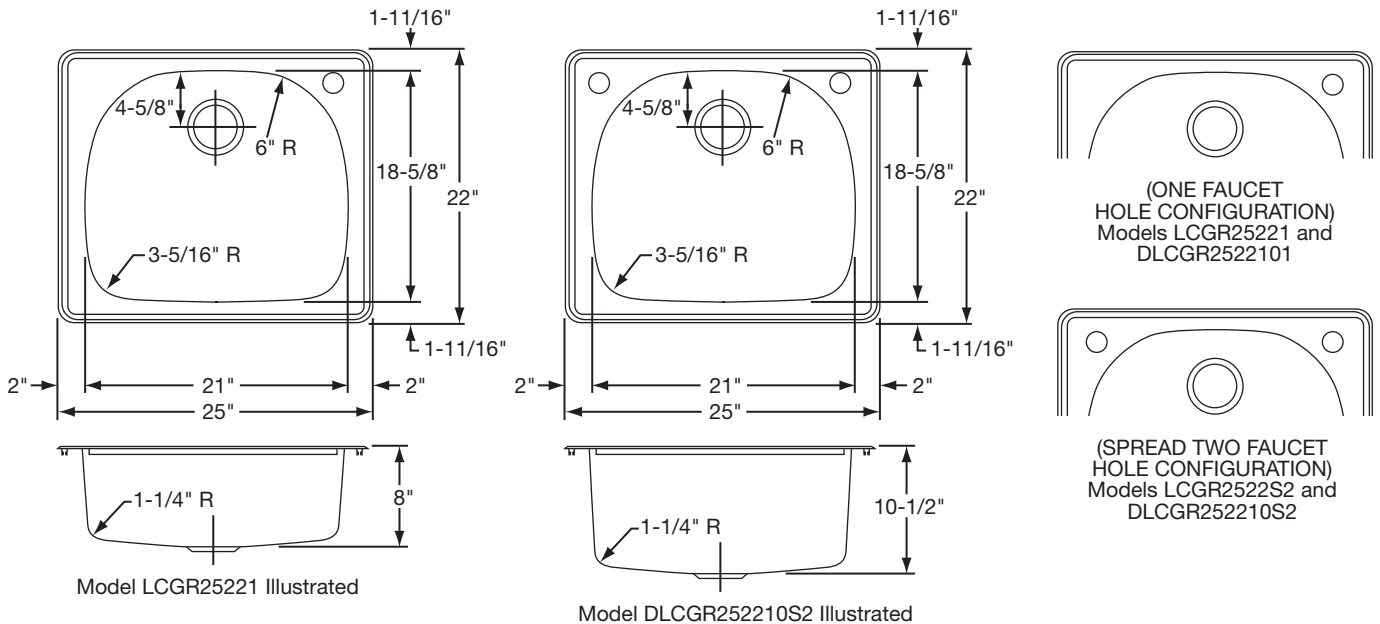

ALL DIMENSIONS IN INCHES, TO CONVERT TO MILLIMETERS MULTIPLY BY 25.4.

In keeping with our policy of continuing product improvement, Elkay reserves the right to change product specifications without notice.

This specification describes an Elkay product with design, quality and functional benefits to the user. When making a comparison of other producers' offerings, be certain these features are not overlooked.